



EUROPEAN
BIENNIAL
OF LANDSCAPE
ARCHITECTURE
BARCELONA
ROSA BARBA
EUROPEAN
LANDSCAPE
PRIZE

PRESS RELEASE

The European Biennial of Landscape Architecture presents the 9 finalist projects for the sixth edition of the Rosa Barba prize

The Biennial will be held in Barcelona from the 30th of September until the 2nd of October under the theme “Liquid Landscapes”

The nine finalist projects will lead the first day of the Biennial’s debates and can be seen in an exhibition which brings together all of those selected

Barcelona, 26th of May, 2010.- The **Rosa Barba European Landscape Prize**, which forms part of the European Biennial of Landscape Architecture, have announced the **nine finalist projects** of this prestigious international contest. On the 1st of October the winner will be announced at a ceremony held at La Pedrera in Barcelona.

This year a total of 427 nominations, from all over the world, were submitted. From these, the international panel of judges have selected 302, from which, the 9 finalists were chosen.

The finalist projects are:

Nansen Park, by Bjørbekk & Lindheim – Tone Lindheim. Fornebu, Oslo (Norway)

Playa Ponente Promenade, by the Office of Architecture in Barcelona – Carlos Ferrater Lambarri, Xavier Martí. Benidorm (Spain)

Recreational Area, by Bureau Alle Hesper – Berrie van Elderen. Heerhugowaard (Holland)

Langedijk Cemetery, by B.G. Brands Architects, S. Karres. Zuid Scharwoude, Langedijk (Holland)

Can Framis Museum Garden, by BAAS + EMF - Jordi Badia - Martí Franch. Barcelona (Spain)

Copenhagen Business School Campus, by Marianne Levinsen Landskab MDL PLR. Frederiksberg (Denmark)

Regeneration of the Port’s Public Space, by Mayslits Kassif Architects. Tel - Aviv (Israel)

Silves Castle Hillside, by Estudos e Projectos de Arquitectura Paisajista, Lda – João Ferreira Nunes. Silves (Portugal)

Urban Park in the Perelló area, by Ruisànceh Architects. Vilablareix, Girona (Spain)

Further information about the projects, is at the end of the press release.

The panel of judges of this 6th edition of the Prize is comprised of **Franco Zagari**, architect and lecturer at the faculty of Architecture of the University of Reggio Calabria (Italy); **Henri Bava**, landscape architect and Grand National Landscape Architecture Prize of France 2007 (France); **Kristine Jensen**, landscape architect and winner of the last edition of the Rosa Barba Landscape Prize (Denmark); **José Manuel Vidal**, architect and editor of 'Paisea' (Spain); and **Nigel Thorne**, president of the EFLA, European Foundation of Landscape Architecture (Great Britain).

Following the death, last month, of the landscape architect and president of the panel of judges Bet Figueras, **Anna Zahonero**, landscape architect and biologist, has joined the panel of judges. The acting president of the panel is Franco Zagari.

Barcelona, capital of European landscape architecture

The Rosa Barba European Landscape Prize is the most prestigious competition of its kind and brings together the most important landscape intervention projects carried out in Europe during the last five years. The award was created in 1999 in Barcelona, in honour of Rosa Barba, the first professor of Landscape Architecture at the Escola Tècnica Superior de Arquitectura, Barcelona (ETSAB) and instigator of the Masters in Landscape Architecture.

The *6th European Biennial of Landscape Architecture* will be held in Barcelona from the 30th of September until the 2nd of October under the theme "Liquid Landscapes" and with China being invited, it will convert Barcelona into the European capital of landscape architecture. The projects selected as finalists for the Rosa Barba Prize will form part of an exhibition that can be visited from the 30th of September at the Institute of Architects of Catalonia (COAC) and seen in a brochure which will be distributed to the leading bookshops around the world.

The *European Biennial of Landscape Architecture* is organised by the Institute of Architects of Catalonia (COAC), the Polytechnic University of Catalonia (PUC), (Masters in Landscape Architecture and the Association of Friends of the PUC) and the Department of Territorial Policy and Public Works (State Architecture and Landscape Office) of the Catalan autonomous government.

The projects:



Nansen Park, by Bjørbekk & Lindheim – Tone Lindheim. Fornebu, Oslo (Norway)

The intervention consisted of creating a new park in the former grounds of an airport. The park has been designed as a dynamic dialogue between the inflexible linearity of the airport, which it is next to, and the more organic and smoother shapes of the original landscape. A film of water crosses the park from north to south, which also includes a square and a large amphitheatre.



Playa Ponente Promenade, by Office of Architecture in Barcelona – Carlos Ferrater Lambarri, Xavier Martí. Benidorm (Spain)

The Promenade is structured as a transitional border which enables, in addition to solving the different problems that were raised —main sewers, rain water course, access with no architectural barriers, etc.—, the construction of a place with a life of its own which can be used as a recreational, leisure or meditation area.



Recreational Area, by Bureau Alle Hoesper – Berrie van Elderen. Heerhugowaard (Holland)

Water is the main element of this intervention which proposes a new recreational and sports and leisure space. The design considers the storage of water and its conservation. Great attention has been paid to the quality of the water, accessibility and to the ability to experiment with the system.



Langedijk Cemetery, by B.G. Brands Architects, S. Karres. Zuid Scharwoude, Langedijk (Holland)

The cemetery, which is surrounded by water, has been divided into themed open-air areas, which hold different types of ashes. These collective areas are connected to each other by a network of public parks that provide space from visual lines which provide continuity to the areas surrounding the complex.

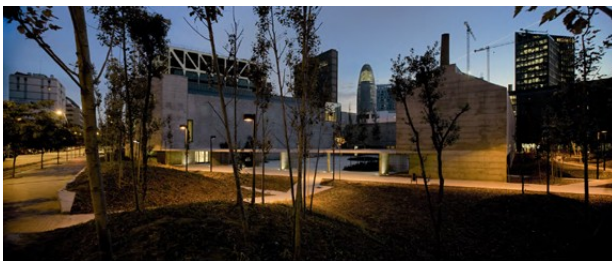

Can Framis Museum Garden, by BAAS + EMF - Jordi Badia - Martí Franch. Barcelona (Spain)

The romantic design of the garden, which contains essential elements of the classic Catalan garden, accompanies the melancholy of the building, which has been subject to several interventions over the years, and contrasts with the frenetic pace of the area where it has been placed, the 22@ district.



Copenhagen Business School Campus, by Marianne Levinsen Landskab MDL PLR. Frederiksberg (Denmark)

The campus area is located at the back end of the city and it has been transformed into an open urban area with movement. To reinforce and to keep the large space joined to the city and, at the same time, to create a green extension, numerous lines of oak trees have been planted, creating a new park inside the university campus.



Regeneration of the port's public space, by Mayslits Kassif Architects. Tel - Aviv (Israel)

The project was conceived as a unique opportunity to construct a public space for the new waterfront which assumed a challenge for the contrast between private and public development and suggests a new approach for the hospitality of collective open spaces.



Silves Castle Hillside, by Estudos e Projectos de Arquitectura Paisajista, Lda – João Ferreira Nunes. Silves (Portugal)

The intervention implies, on the one hand, the definition of the castle's access and, on the other, the design of the entrance area and the service building, which has been sited on an intermediate level. A system of ramps have been fitted which arrange the new routes elegantly and sensitively and provide a privileged view over the city and the countryside.



Urban Park in the Perelló area, by Ruisánchez Architects. Vilablareix, Girona (Spain)

The park was devised to be a system of alluvial terraces, arranged in parallel to the river Güell to enable an increase in the capacity of the water course with avenues of water. The park conserves abundant riverside vegetation. The project's social success is, without doubt, its best endorsement.

You can download pictures by clicking on:

http://www.coac.net/fotos/VI_Biennial_Paisatge/index.htm

www.coac.net/landscape

To request pictures of the finalist projects or for more information:

Institute of Architects of Catalonia
Communications Department
Tel.: +34 93 306 78 45
E-mail: comunicacio@coac.cat